

# POWERFRESH™ DELUXE

USER GUIDE  
1979 SERIES

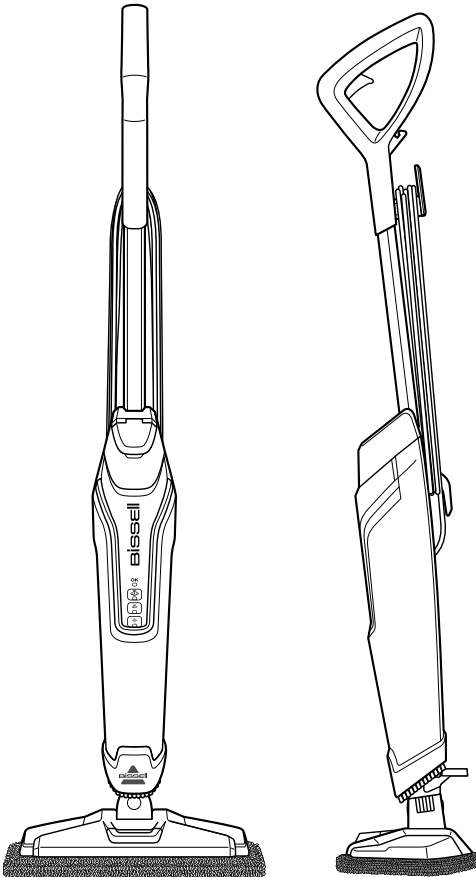

# IMPORTANT SAFETY INSTRUCTIONS

## READ ALL INSTRUCTIONS BEFORE USING YOUR APPLIANCE.

When using an electrical appliance, basic precautions should be observed, including the following:

### **WARNING**

#### **TO REDUCE THE RISK OF FIRE, ELECTRIC SHOCK, OR INJURY:**

- » This appliance can be used by children aged from 8 years and above and persons with reduced physical, sensory or mental capabilities or lack of experience and knowledge if they have been given supervision or instruction concerning use of the appliance in a safe way and understand the hazards involved. Cleaning and user maintenance shall not be made by children without supervision.
- » Children should be supervised to ensure that they do not play with the appliance.
- » If the supply cable is damaged, it must be replaced by the manufacturer, its service agent, or similarly qualified person in order to avoid a hazard.
- » Keep hair, loose clothing, fingers, and all parts of body away from openings and moving parts of the appliance and its accessories.
- » Do not leave appliance when plugged in.
- » Unplug from electrical socket when not in use and before servicing.
- » Do not allow to be used as a toy.
- » Use only as described in this user guide.
- » Use only manufacturer's recommended attachments.
- » Do not use with damaged cable or plug.
- » Do not immerse in water or liquid.
- » If appliance is not working as it should, has been dropped, damaged, left outdoors, or dropped into water; do not attempt to operate it and return it to a service center.
- » Do not pull or carry by cable, use cable as a handle, close door on cable, or pull cable around sharp edges or corners.
- » Do not run appliance over cable.
- » Keep cable away from heated surfaces.
- » Do not unplug by pulling on cable.
- » To unplug, grasp the plug, not the cable.
- » Do not handle plug or appliance with wet hands.
- » Do not put any object into openings.
- » Do not use with any opening blocked; keep free of dust, lint, hair, and anything that may reduce air flow.
- » Turn off all controls before unplugging.
- » Use extra care when cleaning on stairs.
- » Do not use to pick up flammable or combustible liquids, such as petroleum, or use in areas where they may be present.
- » Do not pick up toxic material (chlorine bleach, ammonia, drain cleaner, etc.)
- » Do not use appliance in an enclosed space filled with vapours given off by oil base paint, paint thinner, some mothproofing substances, flammable dust, or other explosive or toxic vapours.
- » Do not pick up hard or sharp objects such as glass, nails, screws, coins, etc.
- » Use only on dry, indoor surfaces.
- » Keep appliance on a level surface.
- » Do not pick up anything that is burning or smoking, such as cigarettes, matches, or hot ashes.
- » Do not use without dust bag and/or filters in place.
- » Do not use outdoors or on wet surfaces
- » This appliance is provided with double insulation. Use only identical replacement parts.
- » Do not leave machine running in the same spot without handle fully upright.
- » The appliance is not to be used if it has been dropped, if there are visible signs of damage or if it is leaking.
- » Keep the appliance out of reach of children when it is energized or cooling down.
- » The foot surfaces are liable to get hot during use.
- » Do not direct steam at people, animals, or equipment containing electrical components.
- » Do not use on leather, wax polished furniture or floors, synthetic fabrics, velvet or other delicate, steam-sensitive materials.

### **WARNING**

**ALWAYS CONNECT TO A PROPERLY EARTHED ELECTRICAL SOCKET.**

### **WARNING**

**LIQUID OR STEAM MUST NOT BE DIRECTED TOWARDS EQUIPMENT CONTAINING ELECTRICAL COMPONENTS.**

### **WARNING**

**SURFACE MAY BE HOT. AVOID CONTACT.**



**THIS SYMBOL MEANS  
WARNING: DANGER OF SCALDING**

## SAVE THESE INSTRUCTIONS

**FOR OPERATION ON A 220-240 VOLT A.C. 50/60 HZ POWER SUPPLY ONLY.**

This model is for household use only.

## Thanks for buying a PowerFresh® Deluxe

We love to clean and we're excited to share one of our innovative products with you. We want to make sure your steam mop works as well in years to come as it does today, so this guide has tips on how to use (pages 6-9) and maintain (page 10).

Your steam mop needs a little assembly before you can put it to work, so flip to page 5 and let's get started!

### What's In The Box?

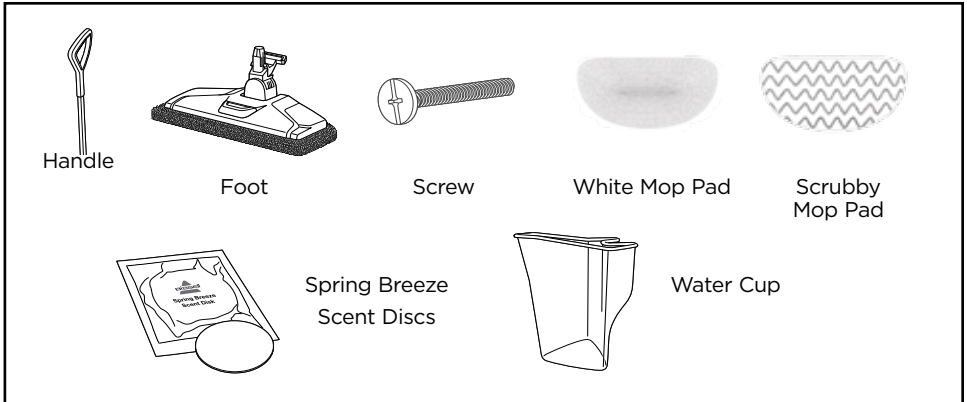

**NOTE:** Standard accessories may vary by model. To identify what should be included with your purchase, please refer to the "Carton Contents" list located on the carton top flap.

Safety Instructions.....2

Maintenance & Care ..... 10

Product View.....4

Guarantee..... 12

Assembly .....5

Consumer Care..... 12

Operations .....6-9

# Getting to Know Your PowerFresh® Deluxe

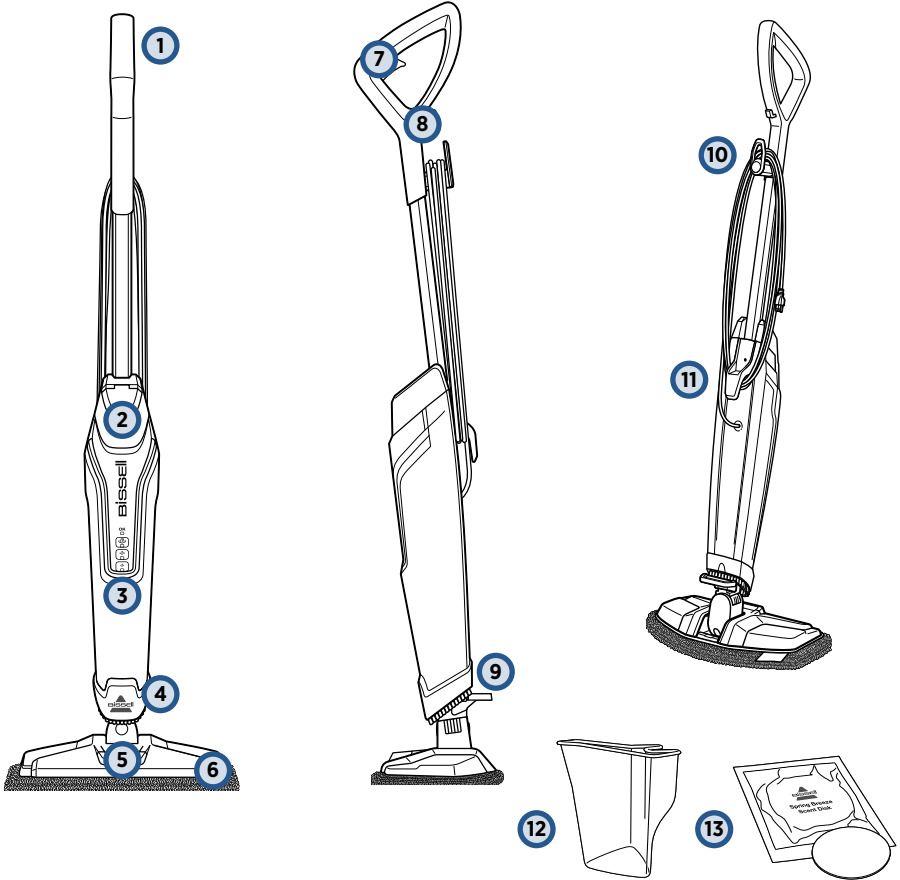

- 1 Strain Reliever Handle™
- 2 Easy Fill Water Tank
- 3 Smart Set™ Steam Control
- 4 SpotBoost Brush™
- 5 Scent Disc Tray
- 6 Edge-Cleaning Mop Head
- 7 On-Demand Steam Trigger

- 8 In-Use Cord Clip
- 9 Pedal to release SpotBoost Brush™
- 10 Quick Release™ Cord Wrap
- 11 Lower Cord Wrap
- 12 Attachable Water Cup
- 13 Spring Breeze Scent Discs

# Assembly

## WARNING

Do not plug in your PowerFresh® Deluxe Steam Mop until you are familiar with all instructions and operating procedures.

Your BISSELL PowerFresh® Deluxe Steam Mop assembles quickly and easily. It is packaged with the following items:

- Handle with one screw
- SpotBoost Brush™
- Machine Foot
- 2 Microfibre Washable Mop Pads
- 2 Spring Breeze Scent Discs
- Water Cup

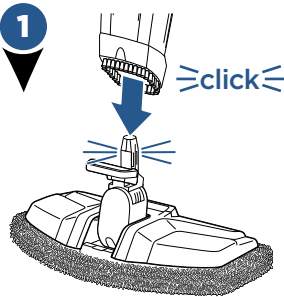

1  
Attach lower body to mop head by snapping it into place.

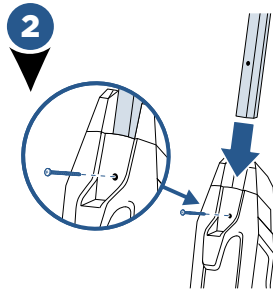

2  
Then, insert handle into body of unit and screw until tightened.

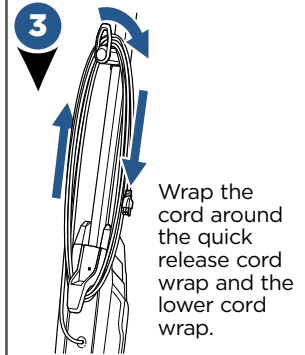

3  
Wrap the cord around the quick release cord wrap and the lower cord wrap.

**NOTE:** To easily unwrap the cord for use, just turn the quick release cord wrap downward to remove the cord from the cord wrap.

## WARNING

Exercise extreme care when using the Steam Mop on timber flooring. Ensure the Steam mop is thoroughly tested in an inconspicuous area prior to mopping a large floor area. The Steam Mop generates hot steam, so when depressing the trigger to apply steam, ensure the Steam Mop is moving continuously. The trigger does not need to be depressed at all times. Prolonged application of steam in one area increases the risk of damage to the surface treatment on timber floors. Check with your timber floor treatment application specialist prior to Steam Mop operation. Regular foot traffic and direct sunlight will wear down timber floor surface treatment making it more susceptible to extreme care when using the Steam Mop on timber flooring.

## WARNING

Never put descaling aromatic, alcoholic, or detergent products into the steam cleaner, as this may damage it or make it unsafe for use. Tinted plates on foot may get hot while steam mop is in use. Do not touch while hot. Upright storage of the PowerFresh Steam Mop with a wet mop pad may result in the formation of white marks on your floor. To remove the white marks, clean area with vinegar.

# Filling Your Water Tank

1

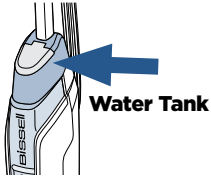

The clean water tank is located on the top of the body of the machine.

2



Lift the water tank cap straight up to open.

3

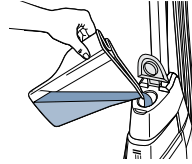

Use water cup provided and fill with distilled or demineralized water, recommended in place of tap water. Close the water tank cap after filling.

## A few notes about filling the Water Tank:

- The Water Tank's capacity is 560 mL (19 oz). **DO NOT USE CHEMICALS IN THE WATER TANK OF YOUR POWERFRESH® DELUXE STEAM MOP.**

# Attaching Microfibre Mop Pads

1

Your PowerFresh® Deluxe Steam Mop may have come with two different pads.



White Mop Pad



Scrubby Mop Pad

The White Pad is best for everyday use on delicate flooring like hardwoods and laminate. The Scrubby Pad is best to use for scrubbing heavily soiled floors and cleaning tougher messes.

2

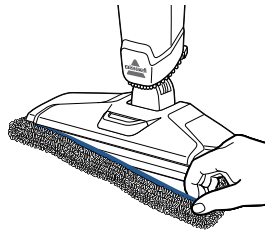

To attach mop pad, wrap mop pad around the bottom of the foot, making sure the gray stitching is located on the front of the foot and the Quick Grip Release™ Tab is located on the back.

# Using SpotBoost Brush™

1

Step down on the pedal located on the back of the machine and lift up to expose the SpotBoost Brush™ located on the bottom of the unit.

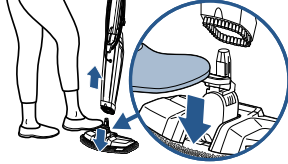

2



Using the SpotBoost Brush™, move back and forth to easily clean grout, crevices and sticky messes.

## **⚠** WARNING

Do not step on the back pedal to recline the unit. When removing the SpotBoost Brush™, make sure to lift away from your body as the bottom of the brush will release steam. Excess effort on the brush may be abrasive to some surfaces; test first.

# Using Scent Discs Tray

1

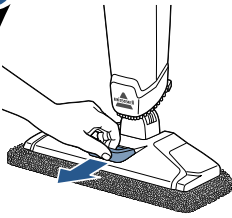

To insert scent discs, pull the tray located on top of mop head out to open.

2

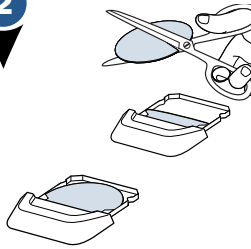

Use a whole disc for a refreshing scent or cut disc in half for a lighter scent.

3

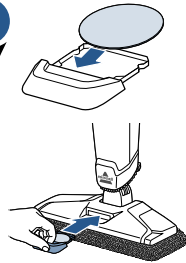

Place scent disc into tray and push tray in to close.

# SmartSet Steam Control

1

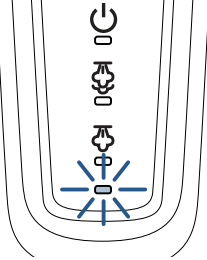

Plug machine into a properly grounded outlet. The READY light will begin blinking. The blinking light indicates the machine is warming up.

2

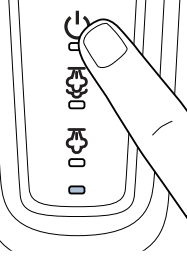

When the blinking light changes to a solid light, press the power button to turn steam on.

3

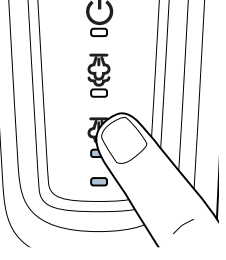

After power button is ON, select the desired steam level based on your cleaning needs. Push the LOW STEAM button once for delicate floors or for light, everyday cleaning. Push again to turn off.

4

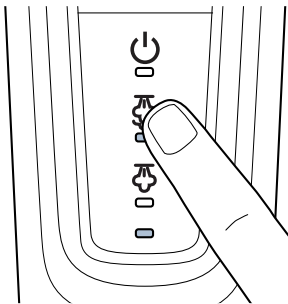

Push HIGH STEAM button once for cleaning durable floors or sticky messes. Push again to turn off.

5

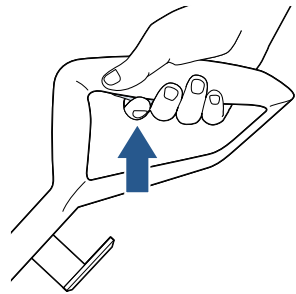

To release steam, pull on-demand trigger.

**NOTE:** After READY light is a solid colour, you must select the POWER button and choose your steam level. Then pull the on-demand trigger on the upper handle to release steam. Upon the first use of your steam mop or first use after refilling the water tank, the pump may make a “knocking” sound. This is normal and will diminish after a few seconds.



# Cleaning Your Hard Floors

**NOTE:** Before you clean, thoroughly sweep or vacuum floor prior to cleaning with the Powerfresh Steam Mop.

**YOUR STEAM MOP IS DESIGNED TO CLEAN HARD FLOORING. USE OF YOUR STEAM MOP ON WAXED OR SOME UNWAXED FLOORS MAY RESULT IN A DIMINISHED GLOSSINESS. FOR BEST RESULTS, TEST IN AN INCONSPICUOUS AREA AND CHECK THE CARE INSTRUCTIONS FROM YOUR FLOORING MANUFACTURER.**

1

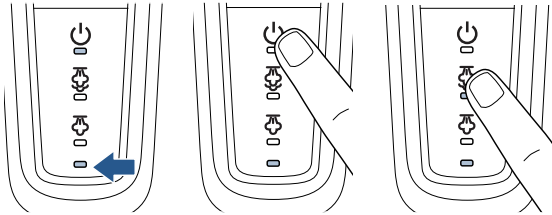

Plug the machine into a properly grounded outlet. Once the blinking READY light turns solid, press the POWER button. Next select the appropriate steam level.

**Press On-Demand Steam Trigger to release steam as desired.**

2



Step on the back of the foot to recline the body of the machine to begin cleaning.

3



To sanitize an area of your floor, use the microfibre cloth pads and slowly and evenly stroke your steam mop back and forth at least three times using continuous steam.

When finished, turn the machine off by pressing the POWER button and unplugging the unit.

**NOTE: For best results, remove the pad and wash after use.**

**NOTE:** For overly challenging and stuck-on messes, step on the release pedal located on the back of the machine and lift up to use the SpotBoost Brush. See page 7. When removing the foot, make sure to lift it away from your body as the bottom of the brush will release steam.

# Maintenance: Cleaning Your Steam Mop

## **WARNING**

To reduce the risk of fire, electric shock or injury, turn power OFF and disconnect plug from electrical outlet before performing maintenance or troubleshooting.

1

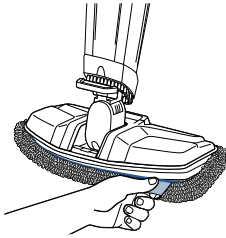

Turn off and unplug the machine from the grounded outlet. Carefully remove mop pad using the Quick Grip Release Tab from the mop head.

2

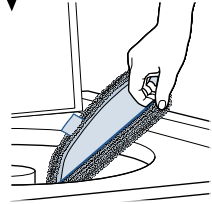

Mop pads can be machine washed in warm water. Use only non-bleach liquid detergents. Do not use fabric softeners or bleach. For best results, air dry.

## **WARNING**

Mop pad and lower assembly may be hot.

3

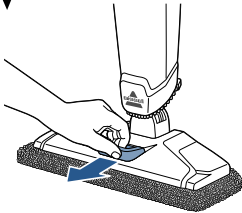

Remove the scent disc from the scent disc tray or replace as needed.

4

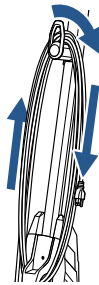

Wrap cord around Quick Release Cord Wrap on the back of the steam mop and wipe all surfaces of the machine with a soft cloth.

5

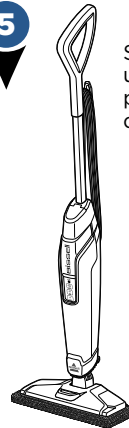

Store upright in a protected, dry area.

# Notes

# Consumer Guarantee

THIS GUARANTEE GIVES YOU SPECIFIC LEGAL RIGHTS, IN ADDITION TO RIGHTS YOU MAY HAVE UNDER THE AUSTRALIAN CONSUMER LAW. IF YOU NEED ADDITIONAL INSTRUCTION REGARDING THIS GUARANTEE OR HAVE QUESTIONS REGARDING WHAT IT MAY COVER, PLEASE CONTACT YOUR LOCAL BISSELL CONSUMER SERVICES ON THE DETAILS SET OUT BELOW.

## Limited 2 Year Guarantee (from the date of purchase by original purchaser)

SUBJECT TO THE \*CONDITIONS IDENTIFIED BELOW, BISSELL WILL REPAIR OR REPLACE (WITH NEW OR REMANUFACTURED COMPONENTS OR PRODUCTS), AT BISSELL'S OPTION, FREE OF CHARGE FROM THE DATE OF PURCHASE BY THE ORIGINAL PURCHASER, FOR TWO YEARS ANY DEFECTIVE OR MALFUNCTIONING PART DUE TO MANUFACTURER DEFECT. THIS GUARANTEE APPLIES TO PRODUCT USED FOR PERSONAL PURPOSES, AND NOT COMMERCIAL OR RENTAL SERVICE. THIS GUARANTEE DOES NOT APPLY TO FANS OR ROUTINE MAINTENANCE OR CONSUMABLE COMPONENTS SUCH AS FILTERS, BELTS, BRUSH ROLLS, ETC., DAMAGE OR MALFUNCTION CAUSED BY NEGLIGENCE, ABUSE, NEGLIGENCE, UNAUTHORIZED REPAIR, OR ANY OTHER USE NOT IN ACCORDANCE WITH THE USER'S GUIDE. BISSELL RECOMMENDS THAT THE ORIGINAL PACKAGING BE KEPT FOR THE DURATION OF THE GUARANTEE PERIOD IN CASE SUCH NEED ARISES WITHIN THE GUARANTEE PERIOD THAT THE ITEM NEEDS RE-PACKING AND TRANSPORTATION.

### \*CONDITIONS OF GUARANTEE

SUBJECT TO WHETHER SUCH LOSS IS REASONABLY FORESEEABLE, BISSELL AND ITS IN-COUNTRY DISTRIBUTORS ARE NOT LIABLE FOR INCIDENTAL OR CONSEQUENTIAL DAMAGES OF ANY NATURE ASSOCIATED WITH THE USE OF THIS PRODUCT.

### FOR AUSTRALIAN CONSUMERS ONLY:

OUR GOODS COME WITH GUARANTEES THAT CANNOT BE EXCLUDED UNDER THE AUSTRALIAN CONSUMER LAW. YOU ARE ENTITLED TO A REPLACEMENT OR REFUND FOR A MAJOR FAILURE AND FOR COMPENSATION FOR ANY OTHER REASONABLY FORESEEABLE LOSS OR DAMAGE. YOU ARE ALSO ENTITLED TO HAVE THE GOODS REPAIRED OR REPLACED IF THE GOODS FAIL TO BE OF ACCEPTABLE QUALITY AND THE FAILURE DOES NOT AMOUNT TO A MAJOR FAILURE.

THIS GUARANTEE IS IN ADDITION TO OTHER RIGHTS OR REMEDIES UNDER LAW. NOTHING IN THIS GUARANTEE EXCLUDES, LIMITS OR MODIFIES ANY LIABILITY OF BISSELL WHICH IS IMPOSED BY LAW, OR LIMITS OR MODIFIES ANY REMEDY AVAILABLE TO THE CONSUMER WHICH IS GRANTED BY LAW. TO MAKE A CLAIM UNDER THIS GUARANTEE CONTACT BISSELL AUSTRALIA PTY LTD (DETAILS ABOVE). CONTACT BISSELL PRIOR TO RETURNING ANY GOODS. WHERE AGREED, BISSELL WILL REIMBURSE REASONABLE POSTAGE / HANDLING COSTS (IF ANY) FOR RETURNING GOODS TO BISSELL. TO CLAIM EXPENSES INCURRED IN MAKING A CLAIM UNDER THIS GUARANTEE PLEASE PROVIDE BISSELL WITH A COPY OF THE RECEIPT OF THE EXPENSES BY EMAIL OR POST.

## Consumer Care

If your BISSELL product should require service or to claim under our limited guarantee, please contact us as follows:

### Website and Email:

[www.bissell.com.au](http://www.bissell.com.au)

[www.bissell.co.nz](http://www.bissell.co.nz)

### Telephone:

Australia: 1300-247-735

New Zealand: 0800-247-735

### Write:

BISSELL AUSTRALIA PTY LIMITED  
42 Rocco Dr.  
Scoresby 3179  
Victoria  
Australia

Replacement parts and accessories are available for purchase. To purchase visit [www.BISSELL.com.au](http://www.BISSELL.com.au)

## Visit the BISSELL website: [www.BISSELL.com.au](http://www.BISSELL.com.au)

When contacting BISSELL, have model number of cleaner available.

Please record your Model Number: \_\_\_\_\_ Please record your Purchase Date: \_\_\_\_\_

**NOTE: Please keep your original sales receipt. It provides proof of the date of purchase in the event of a Guarantee claim. See Guarantee for details.**



©2017 BISSELL Homecare, Inc  
Grand Rapids, Michigan  
All rights reserved. Printed in China  
Part Number 161-3886 11/17  
Visit our website at: [www.BISSELL.com.au](http://www.BISSELL.com.au)